

CONOFLAT

- straightlined, purist design
- high level of comfort thanks to the flat enamelled waste cover that is flush with the shower area
- can be installed to be absolutely flush with the floor
- made of Kaldewei steel enamel 3,5 mm
- ideally complements the CONODUO bath
- designed by Sottsass Associati
- drainage capacity KA 120: 0,85 l/s
- drainage capacity KA 120 vertical: 1,4 l/s

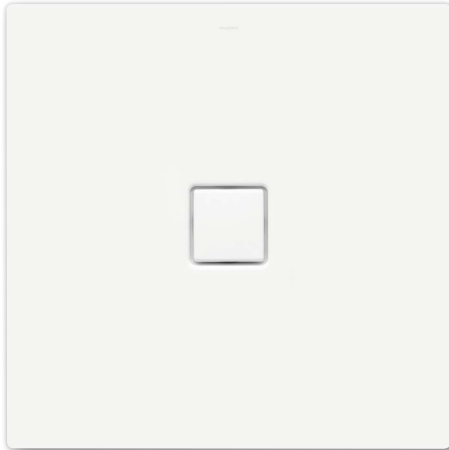

Similar illustration

Mod. 1200 x 1200

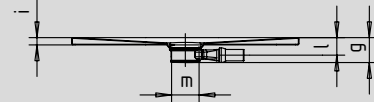

for KA 120 vertical

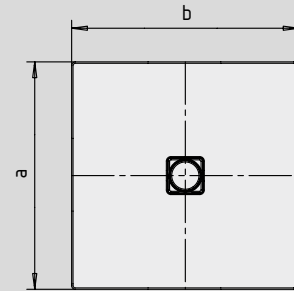
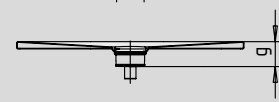

Mod. 1000 x 1200 with support

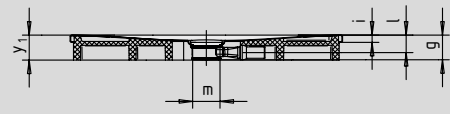

for KA 120 vertical

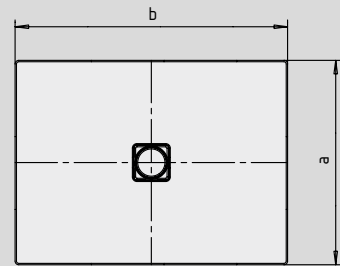
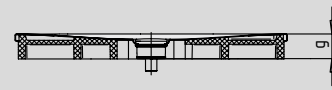

Model No.		855	856	857	858	859	860	861	862	863
External length	a	800	900	1000	750	800	900	1000	750	900 mm
External width	b	1500	1500	1500	1600	1600	1600	1600	1700	1700 mm
Height with siphon	g	107	107	107	107	107	107	107	107	107 mm
Height of rim	i	32	32	32	32	32	32	32	32	32 mm
Diameter of drain hole	m	120	120	120	120	120	120	120	120	120 mm
Siphon connection height	l	76	76	76	76	76	76	76	76	76 mm
Height with support	y ₁	110	110	110	110	110	110	110	110	110 mm
Weight of the enamelled shower tray in kg		33	35	38	30	35	37	41	33	40
Anti-slip		492 x 492	492 x 492	588 x 588	492 x 492	492 x 492	492 x 492	588 x 588	492 x 492	492 x 492 mm
Full anti-slip		740 x 1412	836 x 1412	932 x 1412	692 x 1556	740 x 1556	836 x 1556	932 x 1556	692 x 1652	836 x 1652 mm

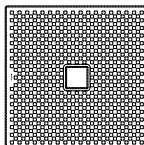

The TÜV Rheinland confirms the following properties of KALDEWEI's anti-slip and full anti-slip finish:

- Assessment group **B** for wet barefoot areas (**DIN 51097**)
- Assessment group **R 10** for slip-resistant properties in work rooms and areas with an increased risk of slipping (**DIN 51130**)

All CONOFLAT models are available with **full anti-slip** finish.